

PS & PSW SERIES Plastic full cone spray nozzles

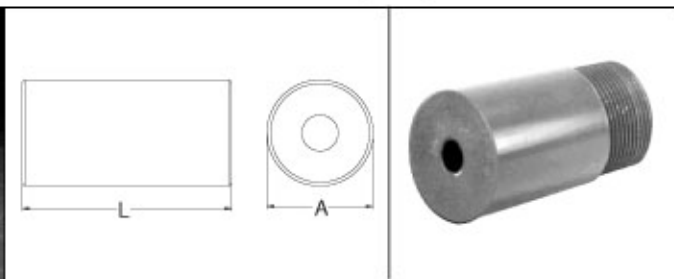
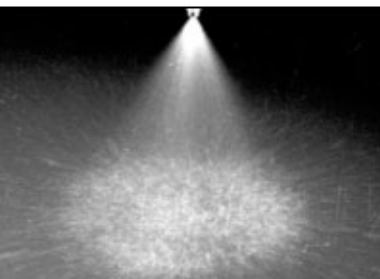

DIMENSIONS

FEMALE FPS (BSPT)	Dim. A (mm)	Dim. L (mm)	MALE PS (BSPT)	Dim. A (mm)	Dim. L (mm)
1 ¹ / ₄ FPS	51	83	1 ¹ / ₄ PS	45	76
1 ¹ / ₂ FPS	64	108	1 ¹ / ₂ PS	51	102
2FPS	76	149	2PS	64	105
2 ¹ / ₂ FPS	89	149	2 ¹ / ₂ PS	76	114
3FPS	102	149	3PS	89	140

SPRAY CHARACTERISTICS:

A full cone spray pattern with large flow capacities. Spray angle is 90° (included angle). Other sizes and spray angles available upon request.

CONSTRUCTION:

The models listed are machined from plastic and consist of a body plus a non-removable insert. Standard materials are PVC, CPVC and polypropylene.

TYPICAL APPLICATIONS:

- Scrubbing and Pollution Control
- Rinsing and Cooling



MODEL NUMBER		PIPE SIZE BSPT	MAXIMUM FREE PASSAGE (mm)	CAPACITY (L/min) AT VARIOUS PRESSURES (bar)								
FEMALE	MALE			0.2 bar	0.3 bar	0.5 bar	0.7 bar	1.5 bar	3 bar	4 bar	5 bar	6 bar
1 ¹ / ₄ FPS17	1 ¹ / ₄ PS17	1 ¹ / ₄	6.4	35	42	55	65	95	134	155	173	190
1 ¹ / ₄ FPS20	1 ¹ / ₄ PS20	1 ¹ / ₄	6.4	41	50	64	76	112	158	182	204	223
1 ¹ / ₂ FPS17	1 ¹ / ₂ PS17	1 ¹ / ₂	6.4	35	42	55	65	95	134	155	173	190
1 ¹ / ₂ FPS19	1 ¹ / ₂ PS19	1 ¹ / ₂	6.4	39	47	61	72	106	150	173	194	212
1 ¹ / ₂ FPS21	1 ¹ / ₂ PS21	1 ¹ / ₂	6.4	43	52	68	80	117	166	191	214	234
1 ¹ / ₂ FPS25	1 ¹ / ₂ PS25	1 ¹ / ₂	7.9	51	62	81	95	140	197	228	255	279
1 ¹ / ₂ FPS29	1 ¹ / ₂ PS29	1 ¹ / ₂	7.9	59	72	93	111	162	229	264	296	324
2FPS20	2PS20	2	6.4	41	50	64	76	112	158	182	204	223
2FPS25	2PS25	2	7.9	51	62	81	95	140	197	228	255	279
2FPS32	2PS32	2	7.9	65	80	103	122	179	253	292	326	357
2FPS40	2PS40	2	9.5	82	100	129	153	223	316	365	408	447
2FPS48	2PS48	2	9.5	98	120	155	183	268	379	438	489	536
2FPS55	2PS55	2	13.5	112	137	177	210	307	434	501	561	614
2FPS60	2PS60	2	13.5	122	150	193	229	335	474	547	611	670
2FPS72	2PS72	2	14.3	147	180	232	275	402	568	656	734	804
2FPS76	2PS76	2	14.3	155	190	245	290	424	600	693	775	848
2FPS84	2PS84	2	15.9	171	210	271	320	469	663	766	856	938
2 ¹ / ₂ FPS84	2 ¹ / ₂ PS84	2 ¹ / ₂	15.9	171	210	271	320	469	663	766	856	938
2 ¹ / ₂ FPS96	2 ¹ / ₂ PS96	2 ¹ / ₂	17.5	196	240	309	366	536	758	875	978	1072
2 ¹ / ₂ FPS108	2 ¹ / ₂ PS108	2 ¹ / ₂	17.5	220	270	348	412	603	853	984	1101	1206
3FPS70	3PS70	3	14.3	38	175	226	267	391	553	638	713	781
3FPS100	3PS100	3	17.5	204	250	322	381	558	789	912	1019	1116
3FPS115	3PS115	3	17.5	234	287	371	439	642	908	1048	1172	1284
3FPS140	3PS140	3	20.6	285	349	451	534	781	1105	1276	1427	1563

FULL CONE SPRAY

Plastic wide angle full cone spray nozzles

SPRAY CHARACTERISTICS:

A full cone spray pattern with large flow capacities. Similar to the PS series above, but with a wider spray angle of 120° (included angle). Other sizes and spray angles available upon request.

CONSTRUCTION:

The models listed are machined from plastic and consist of a body plus a non-removable

insert. Standard materials are PVC, CPVC and polypropylene.

DIMENSIONS:

Same as PS series (above).

TYPICAL APPLICATIONS:

Same as PS series, but where a wider spray coverage is required.



SAME CAPACITIES AS PS SERIES (above). ADD "W" AT THE END OF THE MODEL NUMBER FOR WIDE ANGLE WHEN ORDERING (IE: 2FPS40W).